

6) In case the compressor is dirty or damaged, the internal pressure can be reduced by means of the special air exhaust screw 341), its value measured with the feeder, and the gun used with the spear only.

GUN SUPPLIED WITH COMPRESSED AIR AT TO ATM.  
TO BE USED WITH THE COMPRESSORE ONLY

Compressor strokes	Stored pressure (atm)	Shot in water
5	45	5 meters
10	50	6 meters
15	60	8 meters
20	75	11 meters
25	100	15 meters

## ASSEMBLING , DISASSEMBLING , UPKEEP OF THE COMPRESSOR

### Disassembling and upkeep

Fig. 1 - Loosen locking screws 327) and 330)

Fig. 2 - Put some pressure and, if necessary, hammer lightly to overcome the resistance of the holding rings against the sliding of the compressor tube.

Fig. 3 - Slide out the compressor with its back support.

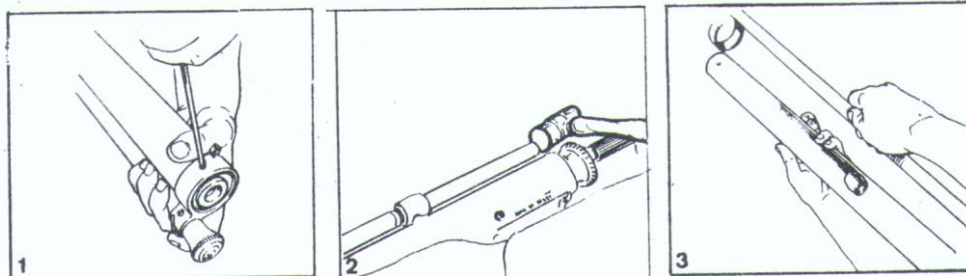

Fig. 4 - Separate the two parts of the compressor tube from the connection part 267) . You can now take off the screw holding the front tube 326b), only to check any damage to the sealing gasket.

Fig. 5 - Unscrew front support 265) having care not to damage nor lose the sealing ring